

## Caratteristiche:

- Design ad alta densità di potenza
- Ridondanza parallela N+X, supporta un massimo di 4 unità in parallelo
- Conversione online a doppio isolamento con controllo DSP
- Armoniche di corrente in ingresso: <3%
- Ampio intervallo di tensione in ingresso: 208~478Vac
- Ampio intervallo di frequenza in ingresso: 40~70Hz
- Corrente di carica massima fino a 20A (regolabile)
- Doppia sorgente di ingresso (opzionale per l'unità standard)
- Display TFT LCD a colori da 2,4 pollici e display LCD da 7 pollici opzionali
- Interfaccia LCD versatile per interazione uomo-macchina
- Compatibile con generatori
- Modalità ECO per il risparmio energetico
- Regolazione intelligente della velocità delle ventole
- Autotest all'avvio dell'UPS
- Modalità convertitore di frequenza 50/60 Hz
- Cold Start
- L'uscita può gestire un carico completamente sbilanciato (100%)
- Funzioni di protezione multiple: cortocircuito, sovraccarico, surriscaldamento, sovraccarica e scarica eccessiva della batteria, bassa tensione in uscita e allarme guasto ventola
- Interfacce di comunicazione multiple: USB, RS232, RS485, porta parallela, contatto a secco, slot intelligente, scheda SNMP (opzionale), scheda contatti a secco (opzionale), sensore temperatura batteria (opzionale)



Battery cabinet  
(Optional)



Optimized battery configuration  
7Ah/9Ah (12V)

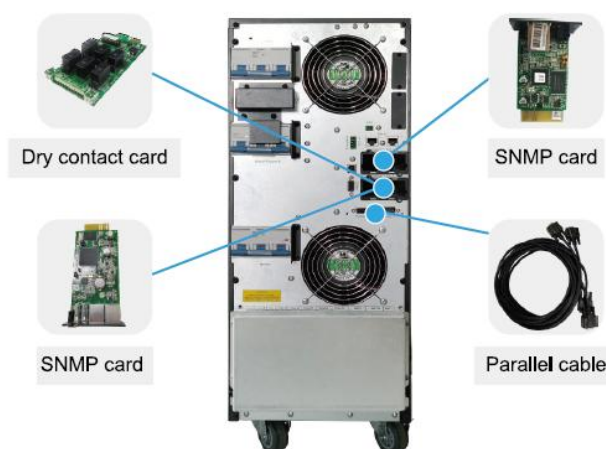

MODEL		YDC3310H	YDC3315H	YDC3320H	YDC3330H	YDC3340H
Capacity (VA/W)		10k/10k	15k/15k	20k/20k	30k/30k	40k/40k
INPUT						
Nominal Voltage (Vac)		380/400/415 (3Ph+N+PE)				
Operating Voltage Range (Vac)		305~478 (Full load); 208~478 (50% load)				
Power Factor		≥0.99				
Harmonic Distortion (THDi)		≤3% Linear load				
Bypass Voltage Range (Vac)		Max.voltage: 220: +25% (Optional +10%, +15%, +20%) 230: +20% (Optional +10%, +15%) 240: +15% (Optional +10%) Min.voltage: -45% (Optional -20%, -30%)				
Bypass Frequency Range (Hz)		50/60±10%				
OUTPUT						
Nominal Voltage (Vac)		380/400/415 (3Ph+N+PE)				
Voltage Regulation		±1%				
Output Frequency (Hz)		Line mode: ±1%/±2%/±4%/±5%/±10% of the rated frequency (Optional); Bat. mode: 50/60 (±0.1%)				
Crest Factor		3:1				
Harmonic Distortion (THDv)		≤2% Linear load; ≤5% Non linear load				
Overload	AC mode	≤110% 60min, ≤125% 10min, ≤150% 1min, >150% immediately turn to bypass				
	Bat.mode	≤110% 10min, ≤125% 1min, ≤150% 5s, >150% immediately shut down				
EFFICIENCY						
AC Mode		Up to 93.5%	Up to 94.5%		Up to 95.2%	
ECO Mode		Up to 98.0%	Up to 98.2%		Up to 98.6%	
BATTERY						
Battery Type		VRLA (Lead acid maintenance free battery)				
Battery Voltage (Vdc)		10~30kVA: ±96/108/120; battery quantity (16~20pcs, 16pcs default, 20pcs no power derating; 18pcs output power factor 0.8/0.9; 16pcs output power factor 0.7/0.8)				40kVA: ±180~300 (30~50pcs)
		±180~300 (30~50pcs)				
Charging Current (Max.)(A)		14	16	18	20	20
ENVIRONMENTAL						
Operating Temperature (°C)		0~40				
Storage Temperature (°C)		-25~55 (No battery)				
Humidity Range		0~95% (Non condensing)				
Altitude (m)		<1000, derating required when>1000				
Noise Level (dB)		<55		<58	<61	<64
PHYSICAL						
Dimension WxDxH (mm)		250×580×655				
Weight (kg)		35	39	40	43	46
STANDARDS						
Safety		IEC/EN 62040-1, IEC/EN 62477-1				
EMC		IEC/EN 62040-2 (IEC 61000-4-2, IEC 61000-4-3, IEC 61000-4-4, IEC 61000-4-5, IEC 61000-4-6, IEC 61000-4-8, IEC 61000-4-11, IEC 61000-2-2)				

MODEL		YDC3350S	YDC3360S	YDC3380S
Capacity (VA/W)		50k/50k	60k/60k	80k/80k
INPUT				
Nominal Voltage (Vac)		380/400/415 (3Ph+N+PE)		
Operating Voltage Range (Vac)		138~305 for 40% load; 305~485 for 100% load		
Power Factor		≥0.99		
Harmonic Distortion (THDi)		≤3% Linear load		
Bypass Voltage Range (Vac)		Max.voltage: 220: +25% (Optional +10%, +15%, +20%) 230: +20% (Optional +10%, +15%) 240: +15% (Optional +10%) Min.voltage: -45% (Optional -20%, -30%)		
Bypass Frequency Range (Hz)		50/60±10%		
OUTPUT				
Nominal Voltage (Vac)		380/400/415 (3Ph+N+PE)		
Voltage Regulation		±1%		
Output Frequency (Hz)		Line mode: Synchronize with input, when the input frequency >±10% (±1%/±2%/±4%/±5% optional), output 50/60 (±0.1); Bat. mode: (50/60±0.2%)		
Crest Factor		3:1		
Harmonic Distortion (THDv)		≤2% Linear load; ≤4% with non linear load		
Overload	Inverter mode			
	Bypass mode			
EFFICIENCY				
AC Mode		Up to 95.5%		
ECO Mode		Up to 99%		
BATTERY				
Battery Type		VRLA		
Battery Voltage (Vdc)		≤110% 60min, ≤125% 10min, ≤150% 1min, >150% immediately shut down inverter		
Charge Current (Max.)		20	40	
ENVIRONMENTAL				
Operating Temperature (°C)		0~40		
Storage Temperature (°C)				
Humidity Range				
Altitude(m)				
Noise Level (dB)		<58	<60	<62
PHYSICAL				
Dimension WxDxH (mm)		600×1000×2000		
Weight (kg)		740	950	1000
STANDARDS				
Safety		IEC/EN 62040-1, IEC/EN 62477-1		
EMC		IEC/EN 62040-2 (IEC 61000-2-2, IEC61000-4-2, IEC61000-4-3, IEC61000-4-4, IEC61000-4-5, IEC61000-4-6, IEC61000-4-8, IEC 61000-4-11)		

MODEL		YDC3350H	YDC3360H	YDC3380H	YDC33100H	YDC33120H	YDC33150H	YDC33160H	YDC33180H	YDC33200H
Capacity (VA/W)		50k/50k	60k/60k	80k/80k	100k/100k	120k/120k	150k/150k	160k/160k	180k/180k	200k/200k
INPUT										
Nominal Voltage (Vac)		380/400/415 (3Ph+N+PE)								
Operating Voltage Range (Vac)		138~305 for 40% load; 305~485 for 100% load								
Power Factor		≥0.99								
Harmonic Distortion (THDi)		≤3% Linear load								
Bypass Voltage Range (Vac)		Max.voltage: 220: +25% (Optional +10%, +15%, +20%) 230: +20% (Optional +10%, +15%) 240: +15% (Optional +10%) Min.voltage: -45% (Optional -10%, -15%, -20%, -30%)								
Bypass Frequency Range (Hz)		50/60±10%								
OUTPUT										
Nominal Voltage (Vac)		380/400/415 (3Ph+N+PE)								
Voltage Regulation		±1%								
Output Frequency (Hz)		Line mode: Synchronize with input, when the input frequency >±10% (±1%/±2%/±4%/±5% optional), output 50/60 (±0.1); Bat. mode: (50/60±0.2%)								
Crest Factor		3:1								
Harmonic Distortion (THDv)		≤2% with linear load; ≤4% with non linear load								
Overload										≤110% 60min, ≤125% 1min, >125% 1.2s shut down inverter
	Bypass Mode	30°C: 135% for long term; 40°C: 125% for long term; >1000%, 100ms								
EFFICIENCY										
AC Mode		Up to 95.5%								
ECO Mode	Inverter Mode	≤110% 60min, ≤125% 10min, ≤150% 1min, >150% 1.2s shut down inverter								
BATTERY										
Battery Type		VRLA/Li-Ion								
Battery Voltage (Vdc)		360~600								
Charging Current(Max.)(A)		20	40			60				
ENVIRONMENTAL										
Operating Temperature (°C)		0 ~ 40								
Storage Temperature (°C)		-25~55 (No battery)								
Humidity Range		0~95% (Non condensing)								
Altitude (m)		1000, derating required when >1000								
Noise Level (dB)		<55	<58	<60	<62		<63		<64	<66
PHYSICAL										
Dimension WxDxH (mm)		250×828×868		442×850×1200						
Weight (kg)		80	83	144	147	152	190	200	220	230
STANDARDS										
Safety		IEC/EN 62040-1, IEC/EN 62477-1								
EMC		IEC/EN 62040-2 (IEC 61000-2-2, IEC 61000-4-2, IEC 61000-4-3, IEC 61000-4-4, IEC 61000-4-5, IEC 61000-4-6, IEC 61000-4-8, IEC 61000-4-11)								